

# “Do-it-Yourself” Landscape Design Kit



GARDEN STORES • LANDSCAPE • NURSERY

Mason Garden Store: 5373 Merten Dr. • (513) 398-2550

Florence Garden Store: 8727 US 42 • (859) 384-3350

513-398-GROW • [www.natorp.com](http://www.natorp.com)

“Your Link to Successful Landscapes”

Kit to be picked up at:  Mason Store  Florence Store

Fee paid: \_\_\_\_\_ Today's date: \_\_\_\_\_ Received by: \_\_\_\_\_

## Professional Landscape Design Solutions for the “Do-it-Yourselfer”

### Landscape Design Kit Questionnaire

Name: \_\_\_\_\_

Address: \_\_\_\_\_

City: \_\_\_\_\_ State: \_\_\_\_\_ Zip: \_\_\_\_\_

Day phone: \_\_\_\_\_ Evening phone: \_\_\_\_\_

**Our main purpose is to assist you in landscaping your yard, or a specific part of your yard, by offering our professional landscape design services to you, the “Do-it-Yourselfer.”** Our design professionals will help design whatever specific area of your yard you would like to work on first. *We will design one area at a time*, so that we may give special attention to that site. It's **very important** to pay attention to details as you describe the specific area to be designed. The more accurate you are with details, measurements, site information, and letting us know what you would like to achieve, the better job we can do providing you with a landscape design.

**Our Design Solution is for landscape design only, and does not include designing for future ponds, fountains, walkways, decks, etc.** We will only design landscaping for the existing conditions. If your landscape design needs to include walkways, ponds, fountains, decks, etc., as well as professional installation of the landscaping and these projects, we suggest you contact our Landscape Division at 398-GROW for more information.

**Fee: There is a minimal fee for our “Do-it-Yourself” Landscape Design Solution.** The fee is for designing one specific area of the yard, such as the entryway, front foundation, screen planting, side of house, deck or patio planting, specialty garden, etc. Check with our Garden Store associates or visit [www.natorp.com](http://www.natorp.com) for the fee amount.

**Your answers to the following questions are the first step in helping to create the yard or garden you want.** Please set aside sufficient time to carefully respond to each question. Attach any additional sheets as necessary, and photographs or digital pictures where indicated. After you have completed this questionnaire, return it to one of our Garden Stores (or mail it to our Landscape Office at 8601 Snider Road, Mason, Ohio 45040), along with a check for the design kit fee. Please allow up to two weeks for us to complete your landscape design. When it is completed, we will contact you to go over your new design.

1. What direction does the area to be designed face? (north, south, east, west) \_\_\_\_\_
2. Are there any extreme weather conditions to be aware of (windy, hot, extreme shade, dry, etc.)? \_\_\_\_\_  
\_\_\_\_\_
3. Do you enjoy working in your yard, or would you prefer spending as little time as possible? \_\_\_\_\_  
\_\_\_\_\_
4. Are there views you wish to preserve or screen with these plantings? \_\_\_\_\_  
\_\_\_\_\_
5. What's the soil like in this area? \_\_\_\_\_
6. Do you have a drainage problem in this section? Notably, does it remain wet for days after it rains, or constantly? \_\_\_\_\_
7. Do we need to consider children playing in this area? \_\_\_\_\_
8. Are there any pets to deal with in this area? \_\_\_\_\_
9. Do you want seasonal color incorporated?  Yes  No
10. Please list any plant favorites, dislikes, or special requests you would like to see incorporated into this area.  
Favorites: \_\_\_\_\_  
Dislikes: \_\_\_\_\_  
Special Requests: \_\_\_\_\_
11. Describe the specific area we are going to be designing, and what it is you'd like to see or achieve with this design.  
\_\_\_\_\_  
\_\_\_\_\_  
\_\_\_\_\_  
\_\_\_\_\_

**Details of the area to be designed: We need your specific details to draw this design to scale.**

- On the back page, draw the area to be designed to scale. (We have given you an example on page 3.) We need to know the amount of space involved so that we may use the correct plant spacings and locations. Please include sidewalks, height of windows (and how far off the ground), the location of water faucets, vents, or anything that may affect your design. The more information you can give us, the better job we can do for you!
- Be sure to indicate existing plants (that you intend to keep) in the area to be designed. (Example: 30' maple by the sidewalk.)
- On this page, paperclip or staple an envelope containing several pictures of the specific area to be designed, and if possible, some of the surrounding area. Several views of the area will help us develop a better landscape design for you. We will do our best to return all pictures.

**ATTACH ENVELOPE CONTAINING PICTURES TO THIS PAGE**

SCALE □ 1 SQUARE = 1 FOOT

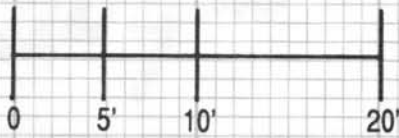

## EXAMPLE

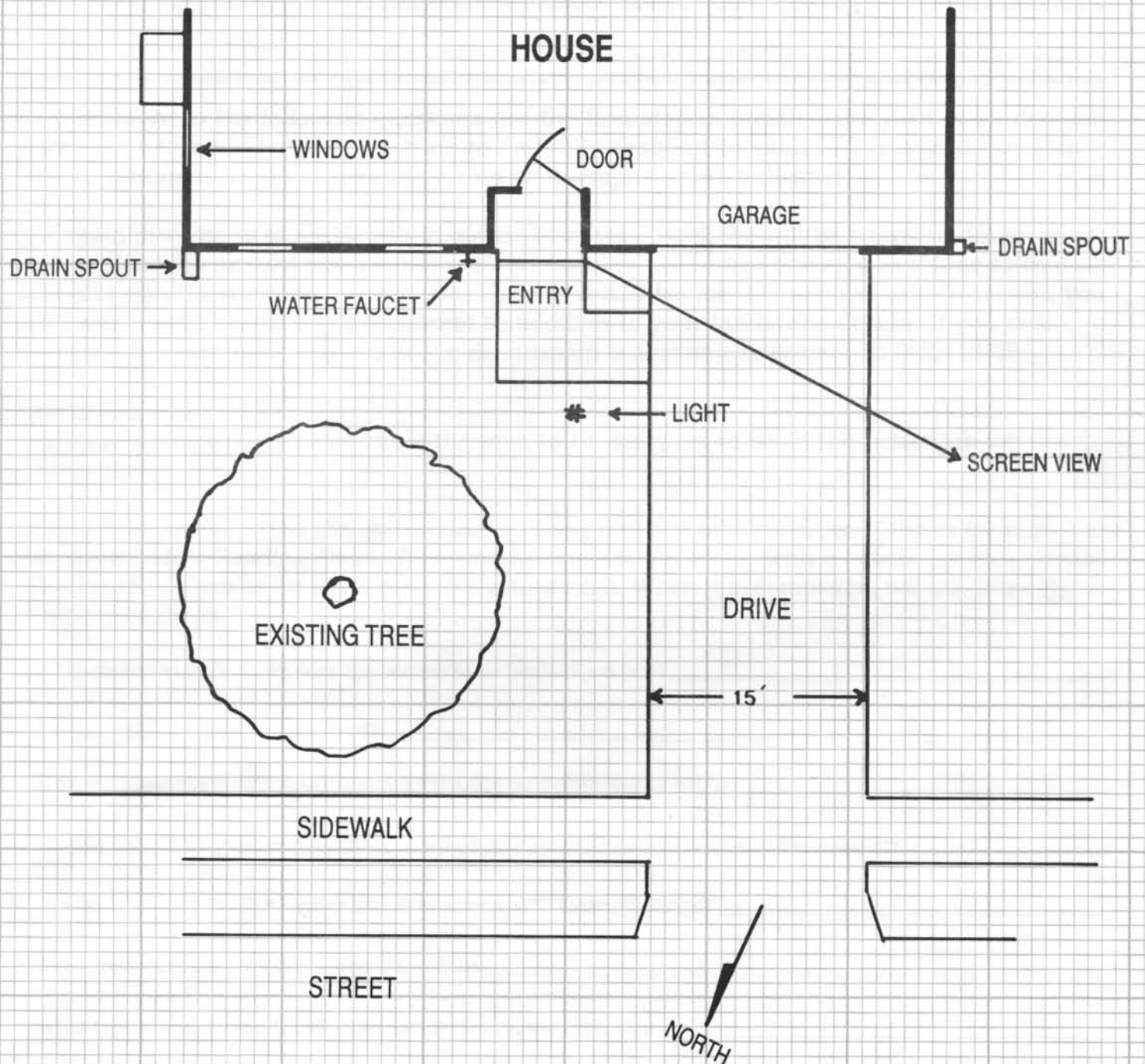

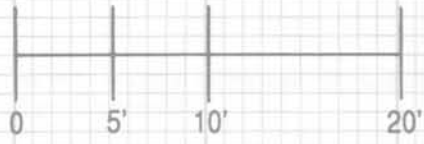

SCALE □ 1 SQUARE = 1 FOOT

**Natorp's**  
INC.

GARDEN STORES • LANDSCAPE • NURSERY

[www.natorp.com](http://www.natorp.com)